

Vaizdas iš viršaus (plane):

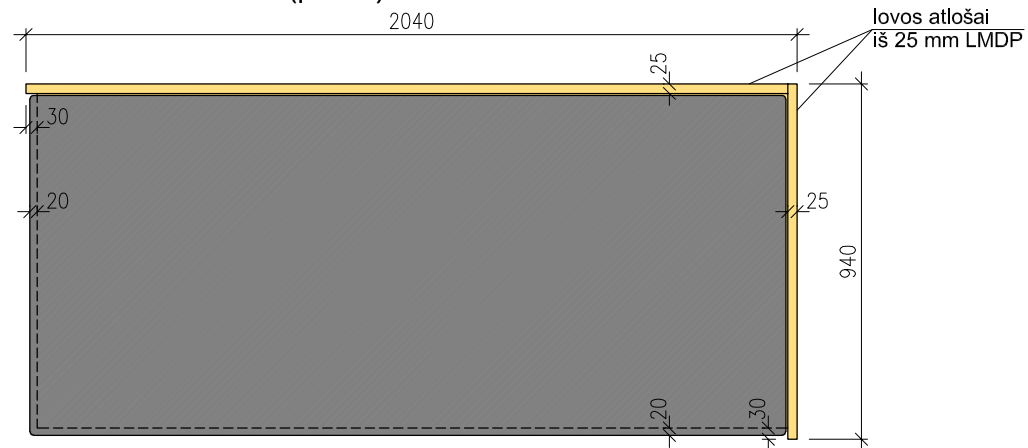

Vaizdas iš priekio:

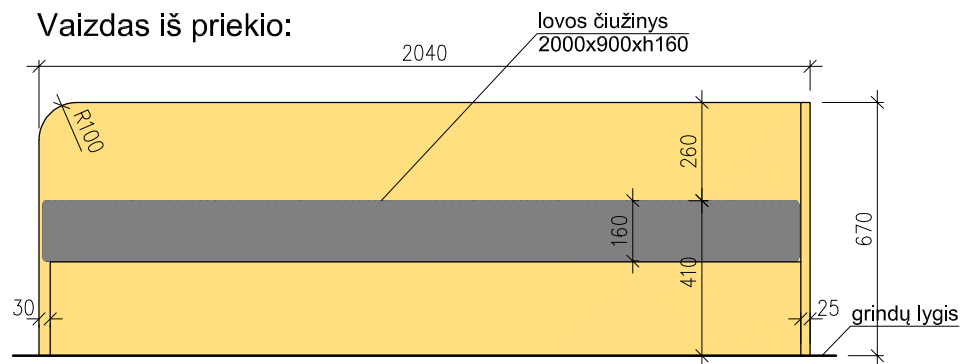

Vaizdas iš šono (iš galo):

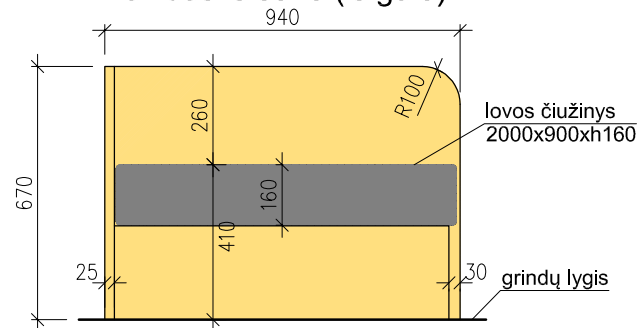

Erdvinis lovos vaizdas:

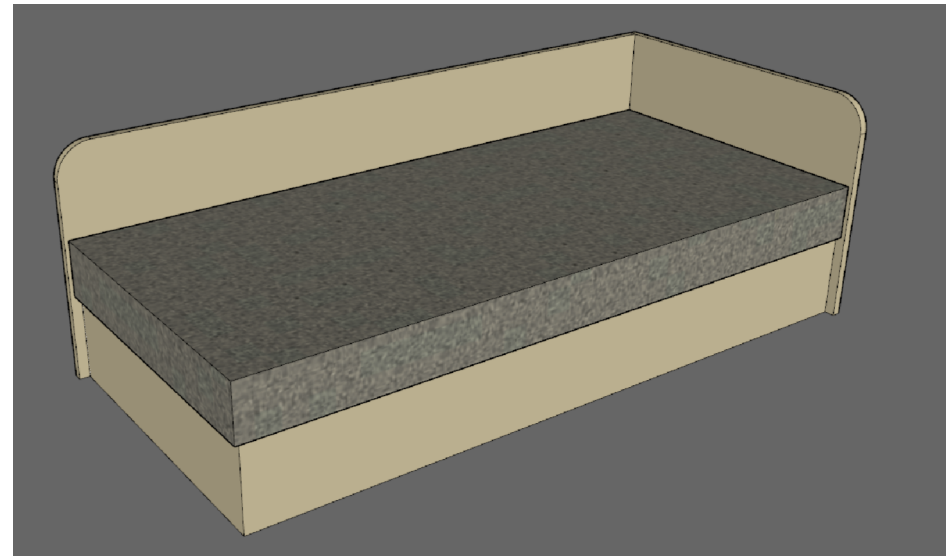

Vaizdas iš viršaus (plane):

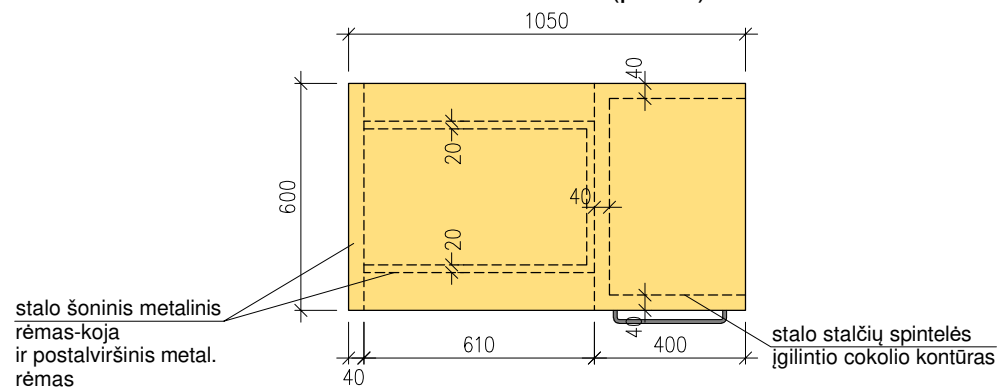

Vaizdas iš priekio:

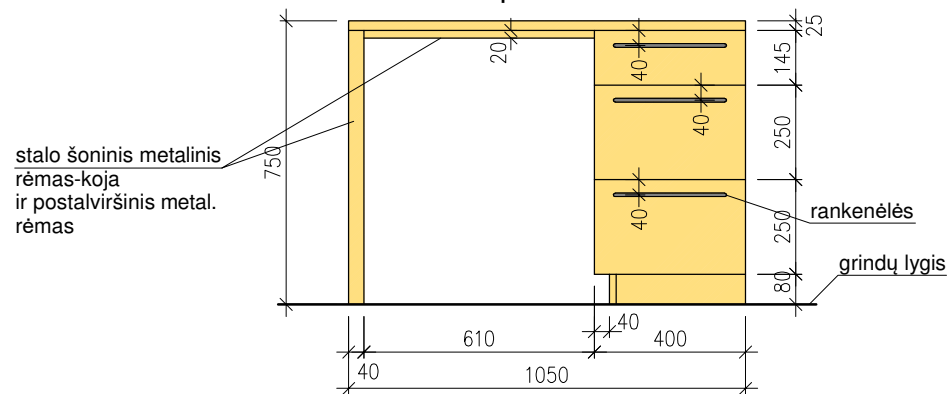

Vaizdas iš šono:

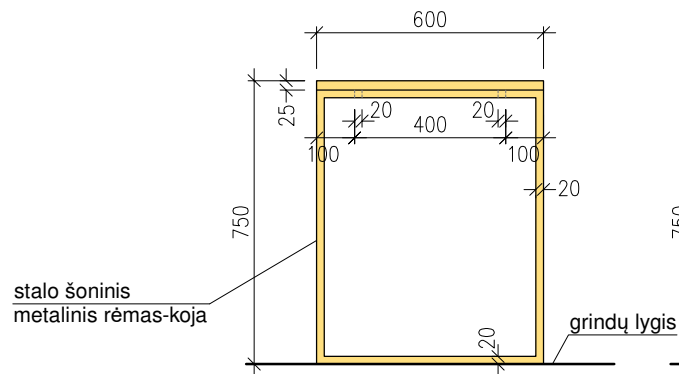

Vaizdas iš šono:

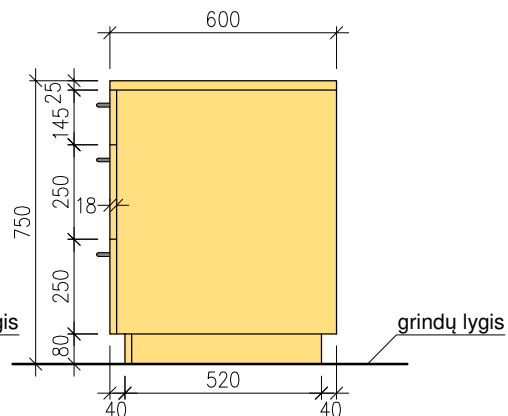

Erdviniai stalo vaizdai:

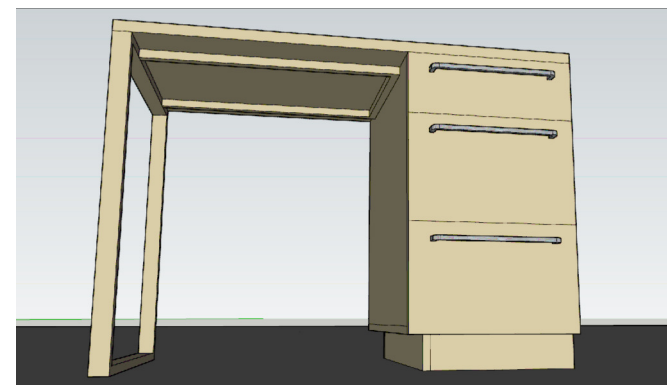

[illegible]

stalo stalčių spintelės
- įgilintio cokolio kontūras

Technical drawing of a kitchen cabinet unit. The unit consists of a base and a wall-mounted upper section. The base is 1050 mm wide and 80 mm high. The wall-mounted section is 750 mm high and 610 mm wide. The base has a 40 mm wide front panel and a 400 mm wide lower section. The wall-mounted section has a 20 mm wide top panel and a 400 mm wide lower section. The lower section of the wall-mounted unit is divided into three compartments, each 250 mm high and 40 mm wide. The compartments are labeled "rankenēlās" (shelves) and "grīdu līgis" (floor level). The overall height of the unit is 830 mm (80 mm + 750 mm). The overall width is 1050 mm (40 mm + 610 mm + 400 mm). The overall depth is 250 mm (25 mm + 145 mm + 250 mm + 250 mm + 250 mm + 80 mm).

rankenèlès

grindų lygis

grindų lygis

Technical drawing of a rectangular structure, likely a wall or partition, showing dimensions and construction details. The overall width is 600 units. The overall height is 750 units. The structure is composed of several layers. The main body is 520 units wide and 520 units high. The top layer is 145 units high. The bottom layer is 80 units high. The side walls are 40 units thick. The drawing includes labels for 'grindų lygis' (floor level) and 'grindų lygis' (floor level).

grindų lygis

A 3D perspective rendering of a wooden desk. The desk features a flat, rectangular top made of light-colored wood. It is supported by a single, thick, vertical leg on the left side. On the right side, there is a cabinet unit with three drawers, each equipped with a long, horizontal silver handle. The entire desk is set against a dark gray background.

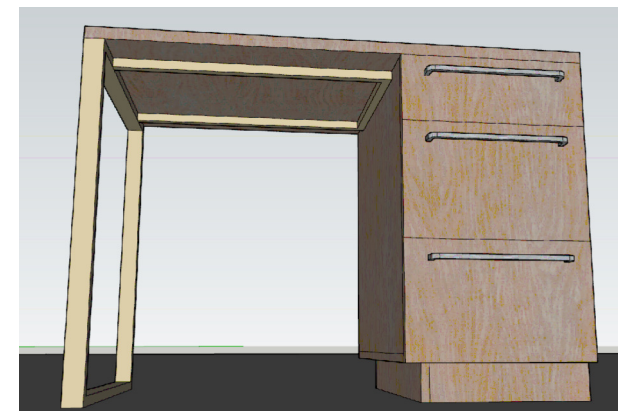

Vaizdas iš viršaus (plane):

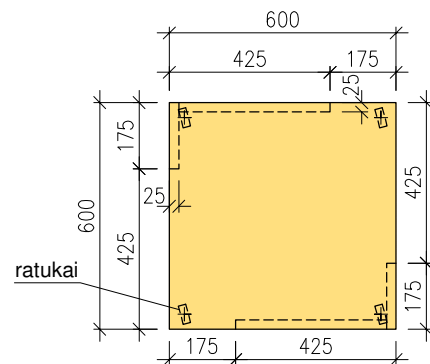

Vaizdas iš 2 šono:

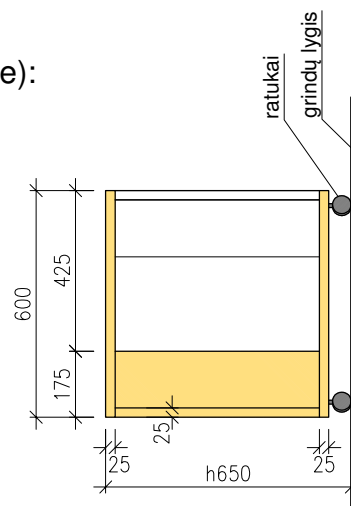

Vaizdas iš 1 šono:

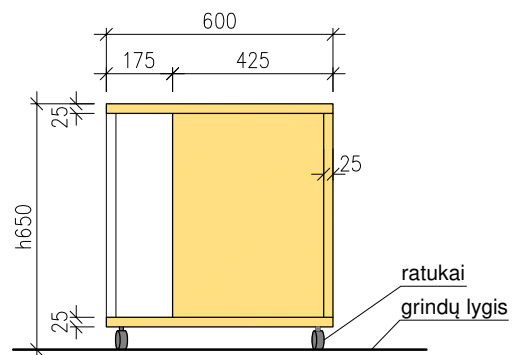

Erdvinis staliuko vaizdai:

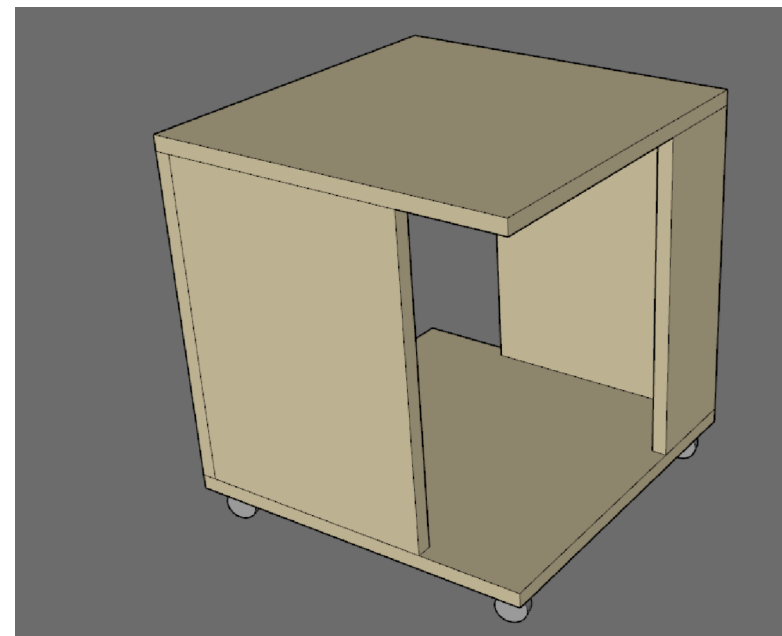

Vaizdas iš viršaus (plane):

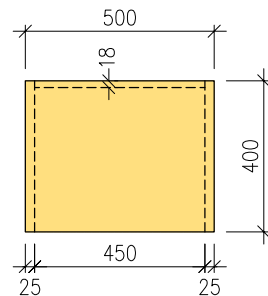

Vaizdas iš priekio:

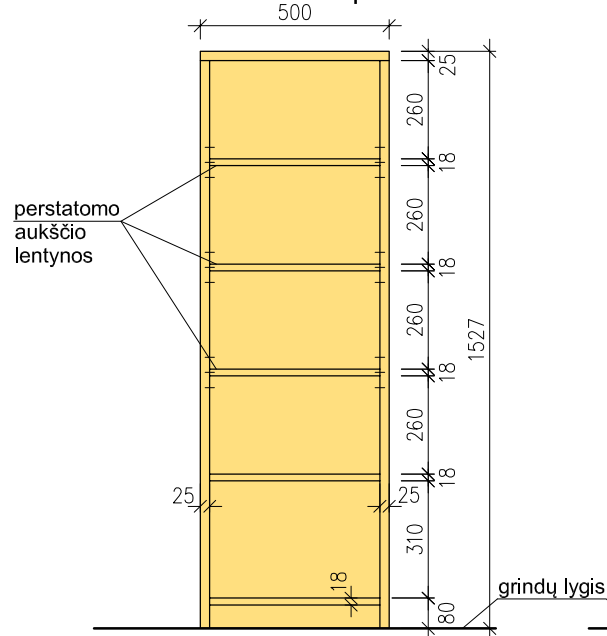

Vaizdas iš šono:

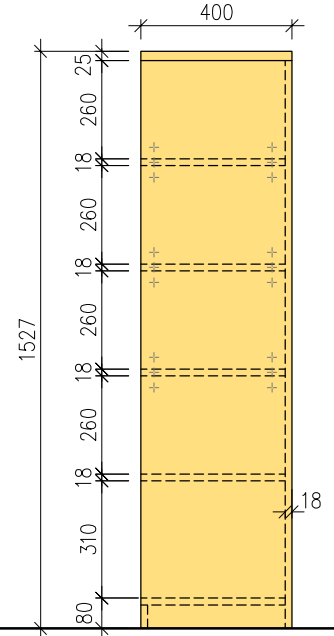

Erdvinis lentynos vaizdas:

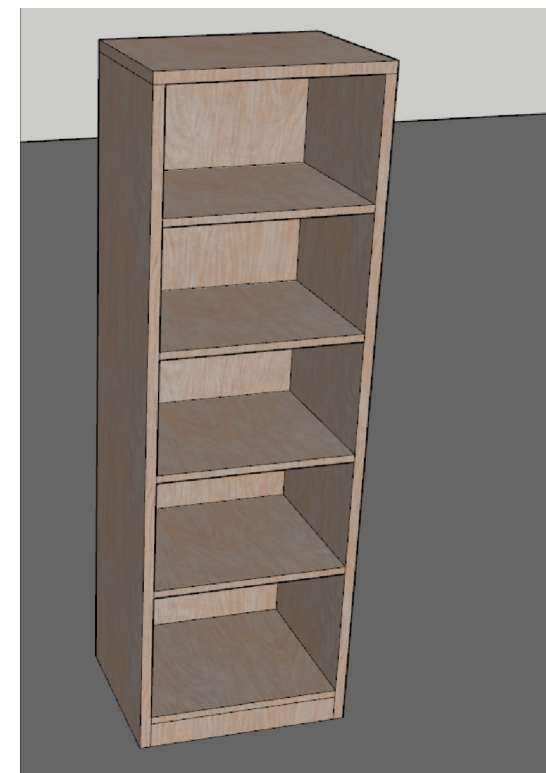

Vaizdas iš viršaus (plane):

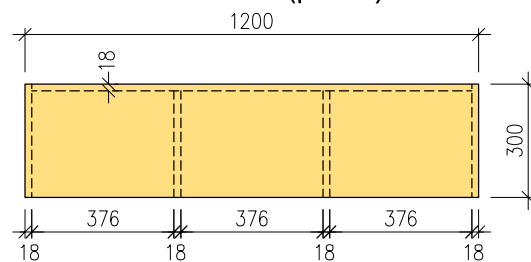

Vaizdas iš priekio:

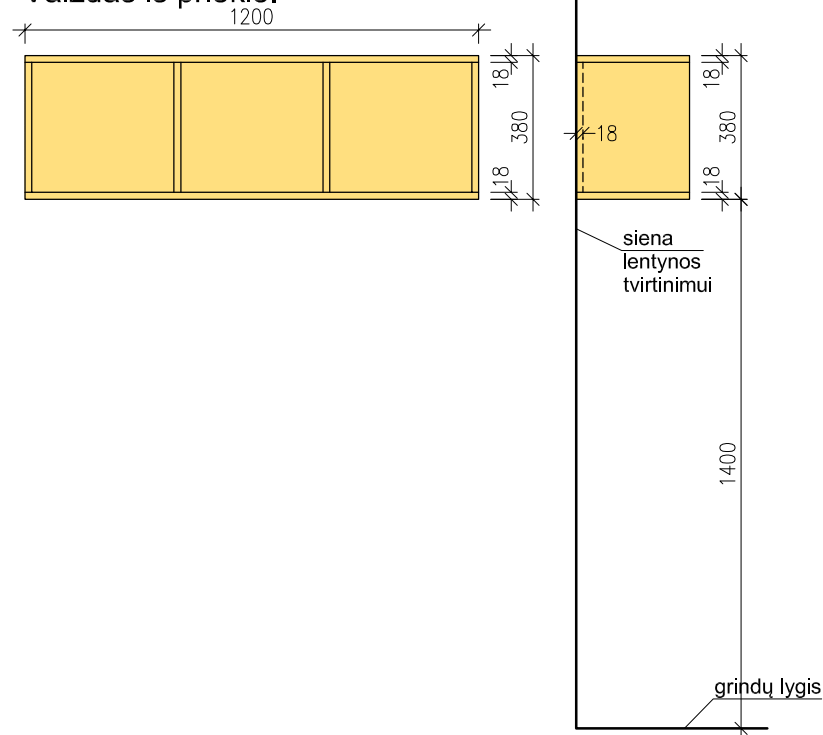

Erdvinis lentynos vaizdas:

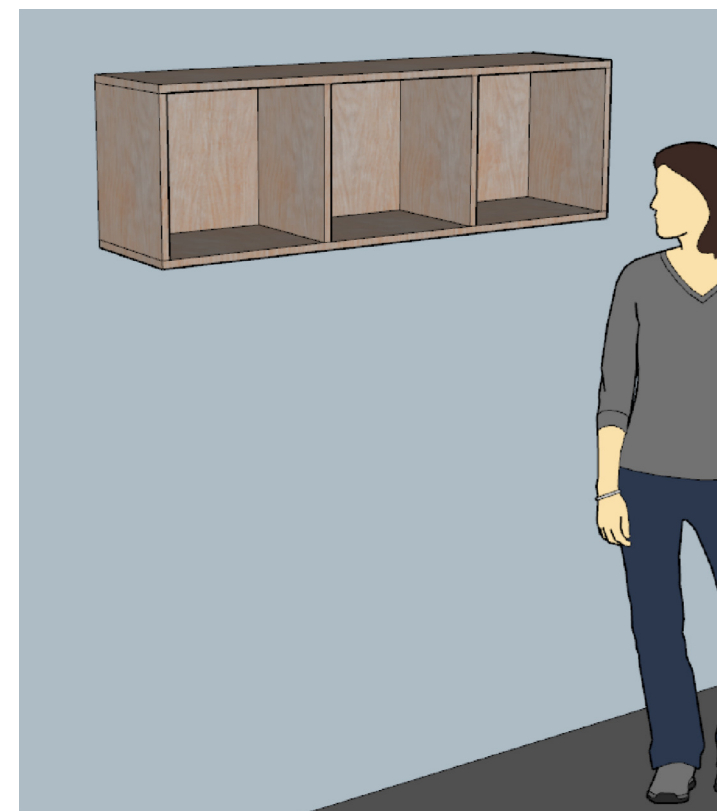

Vaizdas iš viršaus (kampinėje situacijoje):

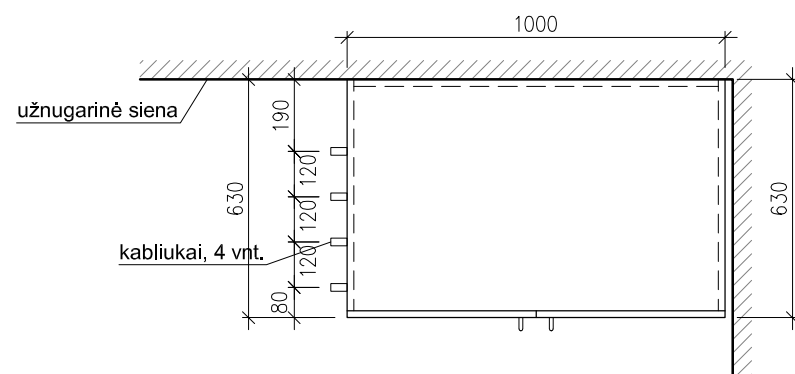

Erdvinis vaizdas:

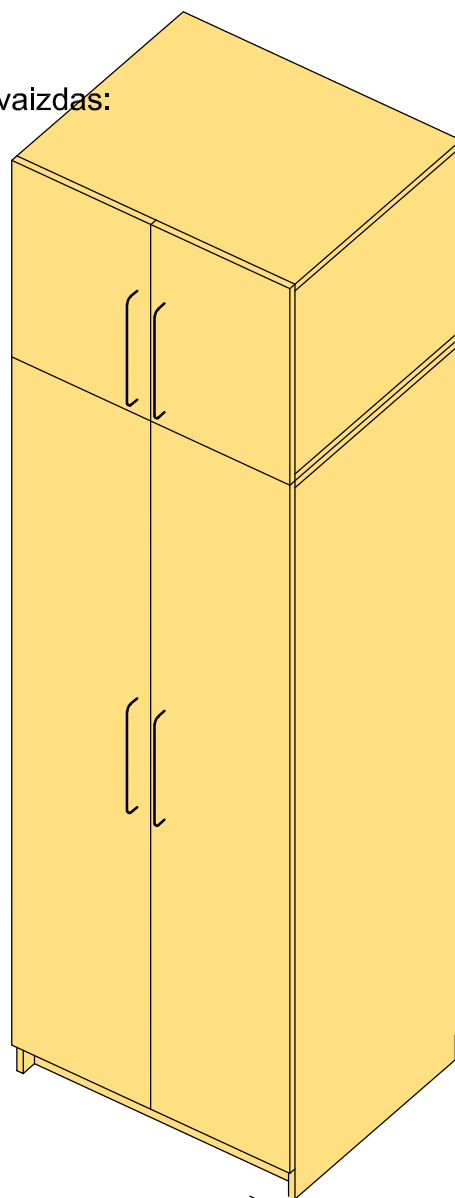

Spintos vaizdas iš priekio:

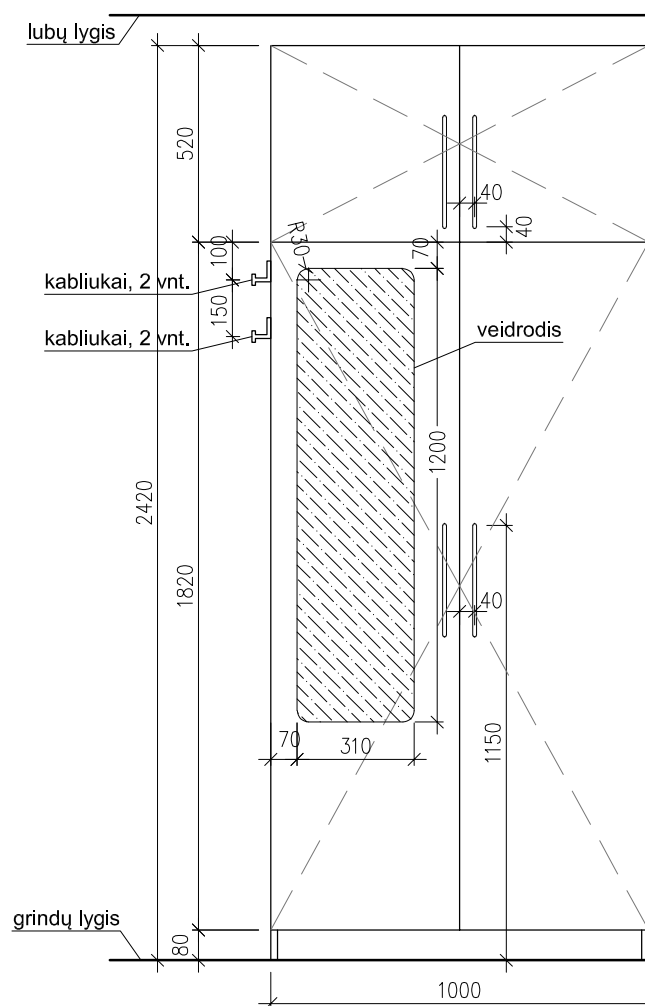

Spintos vidaus vaizdas:

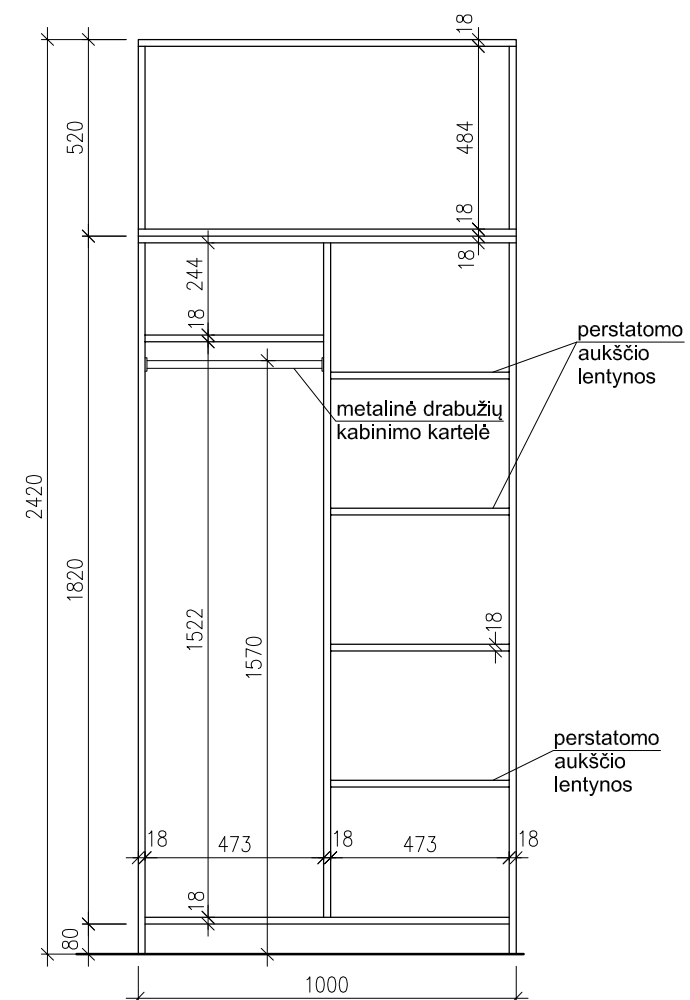

Vaizdas iš šono:

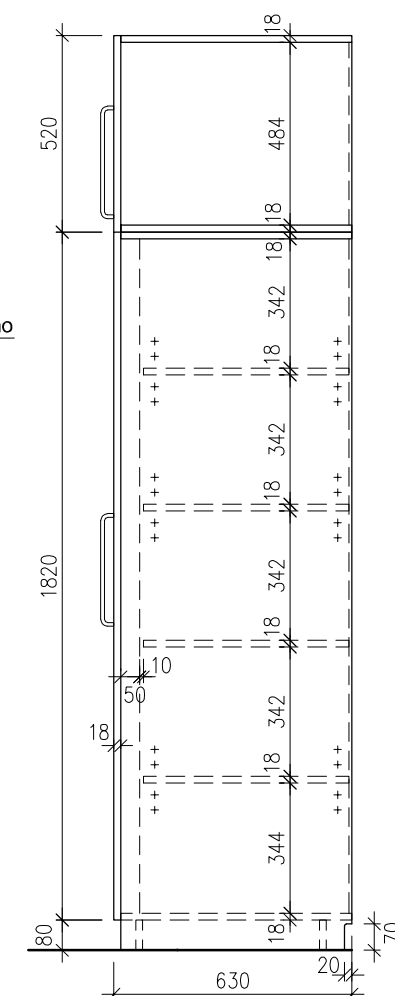

Technical drawing of a three-door cabinet with dimensions and labels in Latvian:

- spintelēs apvadaļi iš 25 mm storio LMDP**: Cabinet door frames made of 25 mm thick LMDP.
- spintelēs vidinis korpusas iš 18 mm storio LMDP**: Internal cabinet body made of 18 mm thick LMDP.
- integrūojama el. orkaitē**: Integrated electric oven.
- integrūojama el. orkaitē**: Integrated electric oven (second instance).
- varstomos fasad. dūrelēs**: Adjustable front handles.

Dimensions:

- Width:** 600 mm.
- Height:** 1618 mm.
- Door Frame Thickness:** 25 mm.
- Internal Body Thickness:** 18 mm.
- Door Frame Spacing:** 20 mm.
- Door Frame Offset:** 25 mm.
- Door Frame Spacing (Bottom):** 120 mm.
- Door Frame Spacing (Bottom):** 125 mm.
- Door Frame Spacing (Bottom):** 120 mm.
- Door Frame Spacing (Bottom):** 5 mm.

Technical drawing of a stationary wall-mounted shelf. The shelf is yellow and rectangular. Dimensions are indicated with dimension lines and arrows:

- Width: 600
- Height: 1618
- Shelf height from floor: 1300
- Shelf thickness: 25
- Shelf depth: 120

Labels with leader lines point to the shelf and the wheels:

- stacionariai prie sienos pritvirtinta lentyna
- ratukai

Technical drawing of a mobile cabinet with dimensions and labels:

- Dimensions:**
 - Width: 650 mm (top left), 3500/3800 mm (top center)
 - Height: 1618 mm (left side), 1300 mm (right side)
 - Internal width: 564 mm (middle left)
 - Internal height: + / - 580 mm (middle left)
 - Base height: 120 mm (bottom left)
 - Wheel height: 125 mm (bottom left)
- Labels:**
 - spintelės apvadai iš 25 mm storio LMDP (cabinet frame from 25 mm thick LMDP)
 - spintelės vidinis korpusas iš 18 mm storio LMDP (cabinet internal body from 18 mm thick LMDP)
 - stacionariai prie sienos pritvirtinta lentyna (stationary wall-mounted shelf)
 - kitų gamintojų-montuotojų statomas virtuvės baldas iš NP su integruotomis plautuvėmis bei kaitlentėmis (kitchen furniture from NP with integrated sinks and hobs, installed by other manufacturers/installers)
 - ratukai (wheels)
 - grindų lygis (floor level)

Technical drawing of a kitchen unit layout. The drawing shows a side view of a kitchen unit with a yellow cabinet body and a white countertop. The unit is divided into a base unit on the left and a wall unit on the right. The base unit has a width of 650 mm and a height of 600 mm. The wall unit has a width of 3500/3800 mm and a height of 200 mm. The wall unit is attached to a wall (užnugarinė siena) and has a curved front edge with a radius of R80. The base unit has a front edge with a radius of R80. The wall unit has a front edge with a radius of R80. The drawing includes labels for various components: 'ratukai' (casters) for the base unit, 'stacionariai prie sienos pritvirtinta lentyna' (stationary wall-mounted shelf) for the wall unit, and 'kitų gamintojų-montuotojų statomas virtuvės baldas iš NP su integruotomis plautuvėmis bei kaitalanėmis' (kitchen unit made of NP with integrated sinks and hobs, assembled by other manufacturers/installers). The drawing also shows a cross-section 'A-A' of the unit.

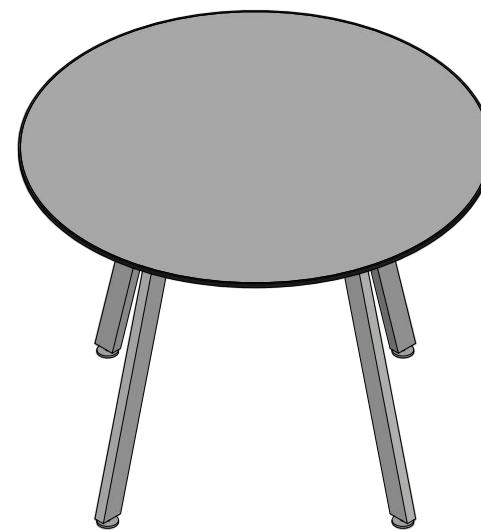
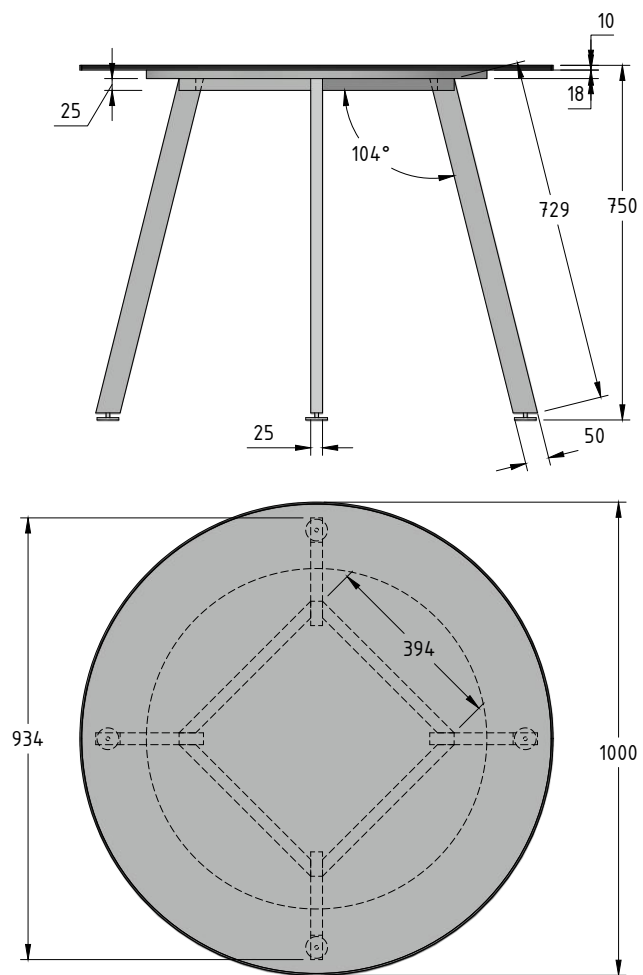

Ažūrinės lentynos-pertvaros priekinis vaizdas

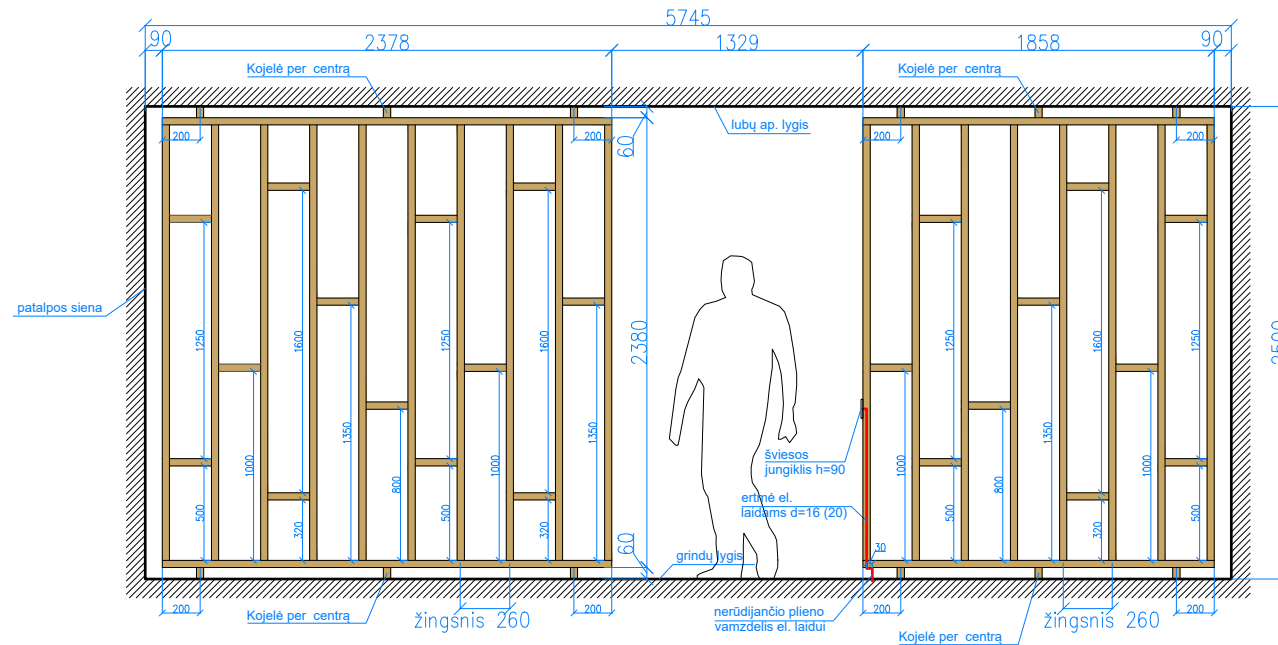

Ažūrinės lentynos-pertvaros vaizdas plane

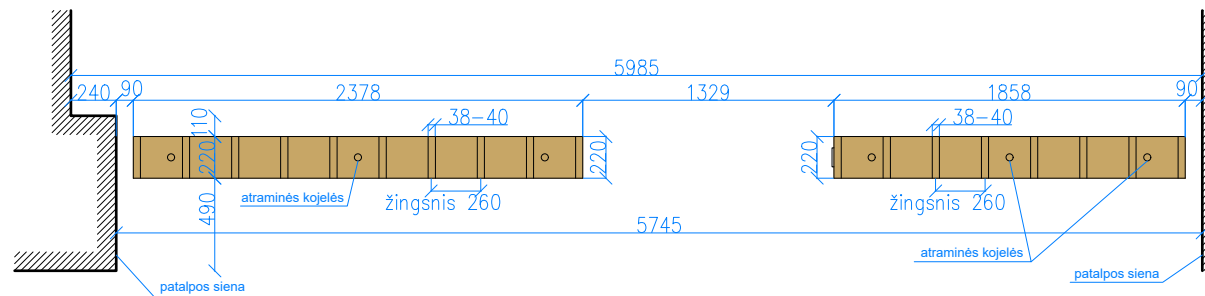

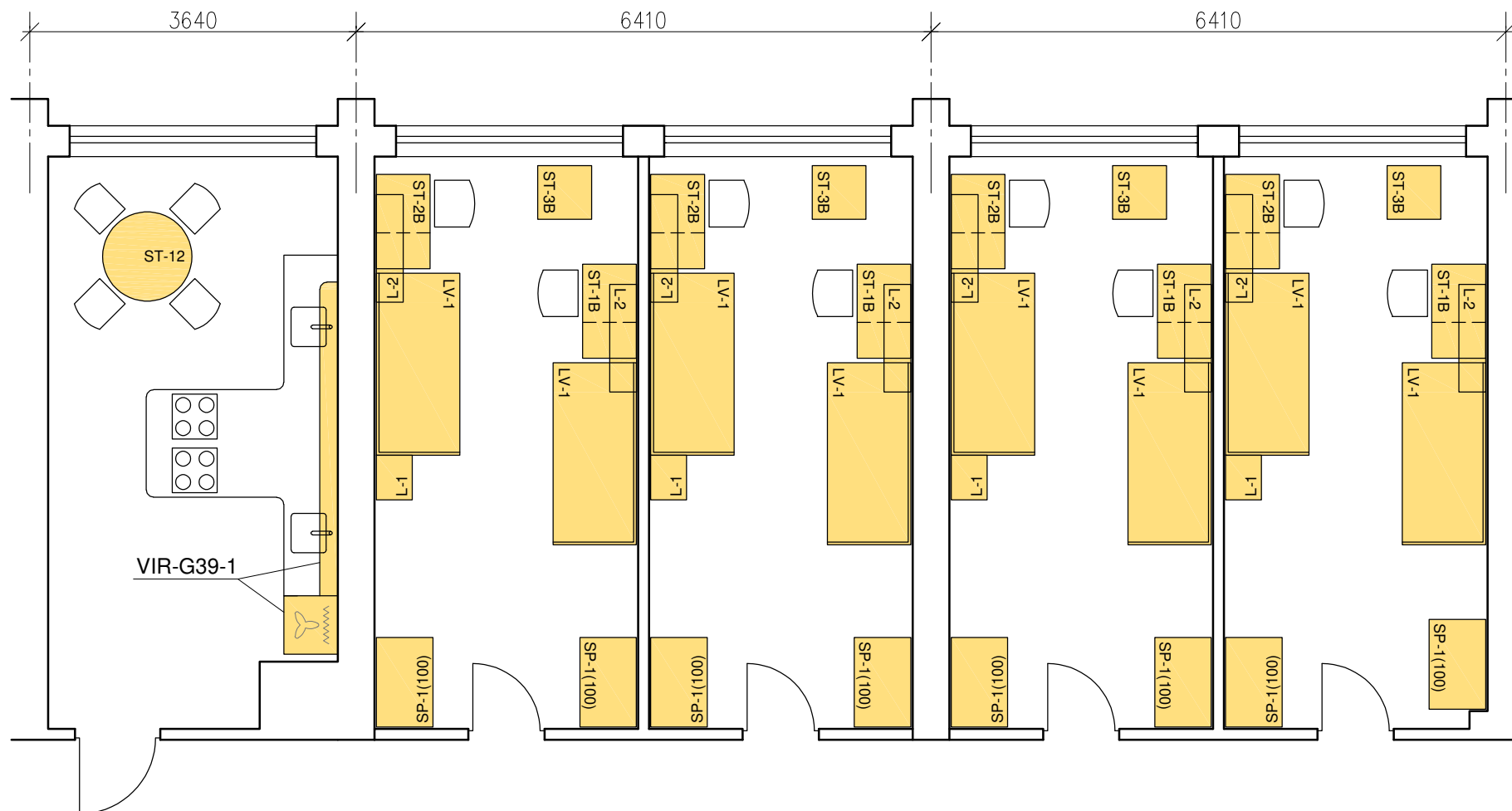

BALDŲ IŠDĖSTYMO PLANO FRAGMENTAS:
BALDAI GYV. KAMBARIUOSE BEI VIRTUVĖJE
(SPAUSDINANT A3 FORMATE, - MASTELIS M1:50)